



B 504 with reset button, push-in enclosure



B 514 with reset button, screw fixture



B 544 with reset button, push-in enclosure

Electro-mechanical Time Meter

Order designation

Order no.	Voltage	Counting capacity
C5B	24 VAC / 50 Hz	99 999.9 h
C8B	110 VAC / 50 Hz	99 999.9 h
C9B	230 VAC / 50 Hz	99 999.9 h
D5E	24 VAC / 50 Hz	9999.99 h
D8E	110 VAC / 50 Hz	9999.99 h
D9E	230 VAC / 50 Hz	9999.99 h
D5H	24 VAC / 50 Hz	999 999 min
D8H	110 VAC / 50 Hz	999 999 min
D9H	230 VAC / 50 Hz	999 999 min

Front dimensions 50 x 25 mm Plug-in arrangm. in push-in enclosure

B 504.600B	<input type="checkbox"/>	<input type="checkbox"/>	Without reset, 99 999.9 h, 9999.99 h
B 504.640A	<input type="checkbox"/>	<input type="checkbox"/>	With key reset, 99 999.9 h, 9999.99 h
B 504.650A	<input type="checkbox"/>	<input type="checkbox"/>	With reset, 99 999.9 h, 9999.99 h
B 504.640E	<input type="checkbox"/>	<input type="checkbox"/>	With key reset, 999 999 min
B 504.650E	<input type="checkbox"/>	<input type="checkbox"/>	With reset button, 999 999 min

Front dimensions 60 x 37.5 mm Mounting to front plate with 2 screws

B 514.650A	<input type="checkbox"/>	<input type="checkbox"/>	With reset, 99 999.9 h, 9999.99 h
------------	--------------------------	--------------------------	-----------------------------------

Front dimensions 53.2 x 28.2 mm Mounting with clamping springs

B 524.600B	<input type="checkbox"/>	<input type="checkbox"/>	Without reset, 99 999.9 h, 9999.99 h
B 524.640A	<input type="checkbox"/>	<input type="checkbox"/>	With key reset, 99 999.9 h, 9999.99 h
B 524.650A	<input type="checkbox"/>	<input type="checkbox"/>	With reset, 99 999.9 h, 9999.99 h

Front dimensions 60 x 37.5 mm Mounting with clamping springs

B 544.600B	<input type="checkbox"/>	<input type="checkbox"/>	Without reset, 99 999.9 h, 9999.99 h
B 544.640A	<input type="checkbox"/>	<input type="checkbox"/>	With key reset, 99 999.9 h, 9999.99 h
B 544.650A	<input type="checkbox"/>	<input type="checkbox"/>	With reset, 99 999.9 h, 9999.99 h

Front dimensions 60 x 50 mm Mounting to front plate with 2 screws

B 574.600B	<input type="checkbox"/>	<input type="checkbox"/>	Without reset, 99 999.9 h, 9999.99 h
B 574.640A	<input type="checkbox"/>	<input type="checkbox"/>	With key reset, 99 999.9 h, 9999.99 h
B 574.640C	<input type="checkbox"/>	<input type="checkbox"/>	With reset button, 999 999 min

Further models, for example with 60 Hz, upon request.

B 504, B 514, B 524, B 544, B 574



B 574 with reset button, clamping fixture

Pin assignment

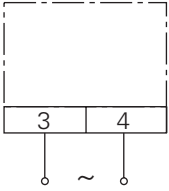

Mechanical data

Display	6-digit, 999 999 digits Approx. 4.5 mm high, white on black background Red decimal display
Reading accuracy	1/100 h = 0.6 min = 36 s 1/10 h = 6 min = 360 s
Counting capacity	99999.9 h, 9999.99 h 999 999 min
Reset	Manual via button or key
Housing material	Plastic, front plate black
Weight	Approximately 160 g

Electrical data

Voltage	24 VAC, 110 VAC, 230 VAC +6/-10 %
Frequency	50 Hz (60 Hz upon request)
Rating	1.5 VA
Running accuracy	Synchronous to supply net
E-connection	With push-in enclosure: Solder terminal or terminal contacts to silver-plated tab connectors 0.8 x 2.8 mm Without push-in enclosure: Contact pin \varnothing 1.5 mm, solder terminal to push-on, silver-plated contact lugs

Accessories

Order no.

Z 100.01A	Flexible transp. protective cover for 1 counter
Z 100.02A	Flexible transp. protective cover for 2 counters
Z 100.03A	Flexible transp. protective cover for 3 counters
Z 100.04A	Flexible transp. protective cover for 4 counters
Z 105.02A	Perspex cover mounted to front frame
Z 107.01A	Front frame, cutout for 1 counter
Z 107.02A	Front frame, cutout for 2 counters
Z 107.03A	Front frame, cutout for 3 counters
Z 107.04A	Front frame, cutout for 4 counters

Ambient conditions

Ambient temperature	0...+60 °C
Storage temperature	-20...+70 °C
Relative humidity	Max. relative humidity 80 %, at 25 °C, non-condensing
Protection	Front IP 41 to DIN 40050
Operational requirements	To contamination factor 2
Classification	According to EN 61010 Category II
Interference immunity	EN 50082-2 Severity grade 2 - 3
Emitted interference	EN 50081-1
General rating	EN 61010
Overvoltage protection	II

B 504, B 514, B 524, B 544, B 574

Dimensions and cutout size

B 504 with reset button, 6-digit

Cutout 50 x 25 mm

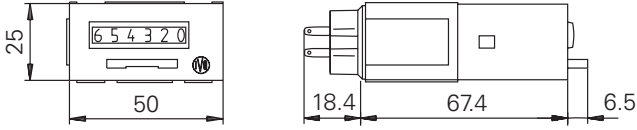

Dimensions and cutout size

B 504 without reset, 6-digit

Cutout 50 x 25 mm

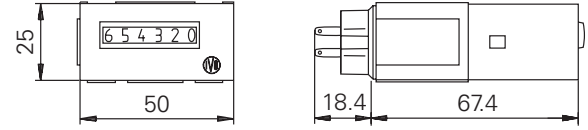

B 514 with reset button, 6-digit

Cutout 51 x 26 mm

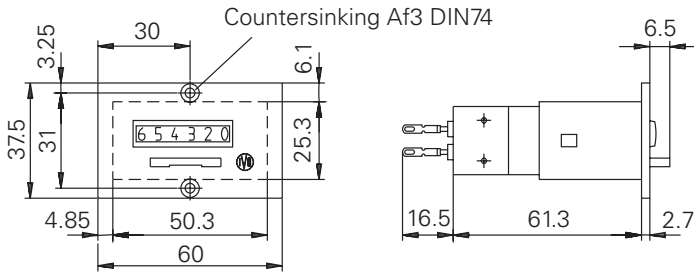

B 524 with reset button, 6-digit

Cutout 51 x 26 mm

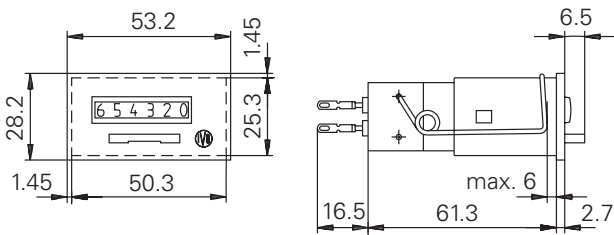

B 524 without reset, 6-digit

Cutout 51 x 26 mm

